

Revised Master Plan

REID POINTE SUBDIVISION

OVERALL MAP FOR
 INDIAN LAND TOWNSHIP
 LANCASTER COUNTY, SOUTH CAROLINA
 SEPTEMBER 4, 2013

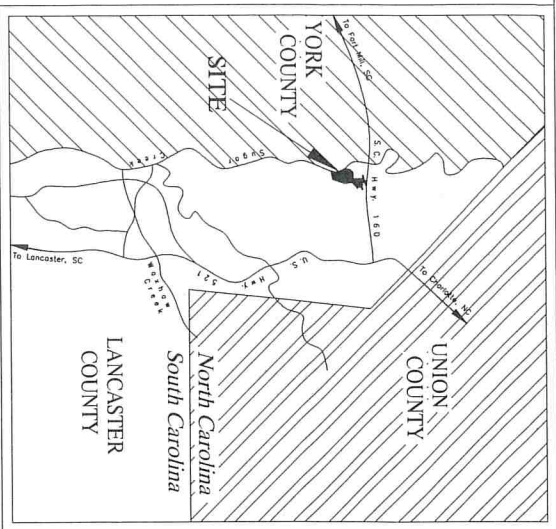

- 50' LOTS PH I MAP I
- 50' LOTS PH I MAP II
- 60' LOTS PH I MAP III
- OPENSOURCE PH I MAP IV
- 70' LOTS PH I MAP V
- 50' LOTS PH I MAP VI
- 50' LOTS PH II MAP I
- 50' LOTS PH II MAP II
- 40' LOTS PH III MAP I
- 40' LOTS PH III MAP II
- 50' LOTS PH V MAP I

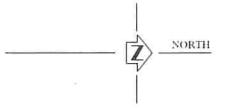
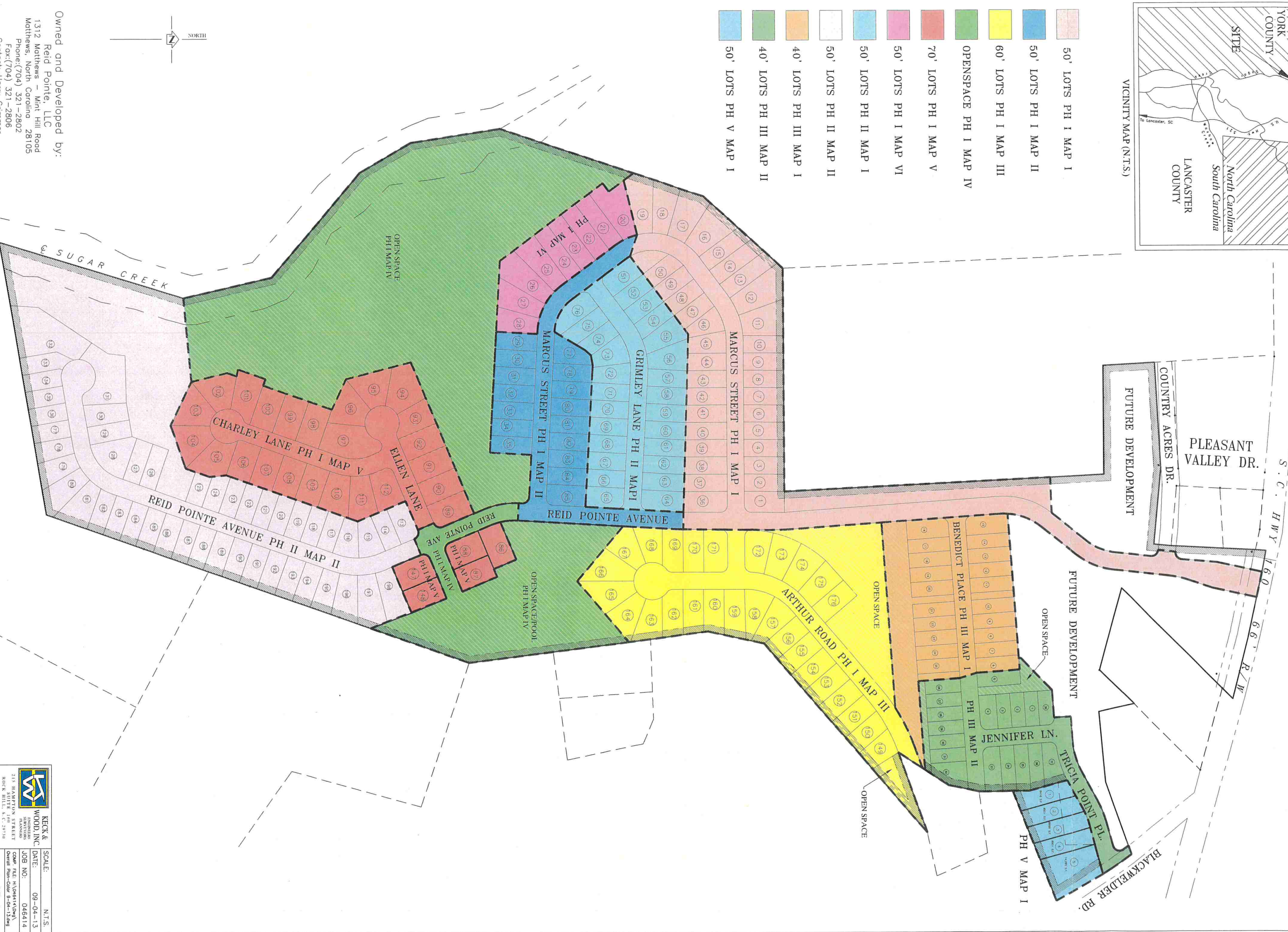

Owned and Developed by:
 Reid Pointe, LLC
 1312 Matthews - Mint Hill Road
 Matthews, North Carolina, 28105
 Phone: (704) 321-2802
 Fax: (704) 321-2806
 Contact: Herry Grimmer

RECEIVED
 9-9-13

	KECK & WOOD, INC. <small>REGISTERED PROFESSIONAL ARCHITECTS</small> <small>215 HAMPDEN STREET</small> <small>ROCKFORD, ILLINOIS 60087</small> <small>PHONE: 815-399-1200</small> <small>FAX: 815-399-1201</small> <small>WWW.KECKANDWOOD.COM</small>	SCALE: N.T.S. DATE: 09-04-13 JOB NO: 066414 COMP. FILE: H:\066414\DWG Overall Plan-Cover 9-04-13.dwg
	1 OF 1	